

# 8M(LOCK) Series

Sub-Miniature Pushbutton Switches



## SPECIFICATIONS

**RATING:** 1A 250VAC, 3A 120VAC or 28VDC

**ELECTRICAL LIFE:** 6,000 cycles.

**CONTACT RESISTANCE:** R=20 mΩ max. ,Q=50 mΩ max.

**INSULATION RESISTANCE:** 1,000 MΩ min., 1000VDC

**DIELECTRIC STRENGTH:** 1,000 VAC for 1 Minute.

**OPERATING TEMPERATURE:** -30°C to 85°C.

**FULL TRAVEL:** 1.88±0.30mm

**OPERATING TRAVEL:** 1.34±0.25mm

**OPERATING FORCE:** 350±100g

## MATERIALS

**CASE:** Diallyl phthalate(DAP) (UL94V-0).

**PLUNGER:** Nylon glass fiber.

**BUSHING:** Brass,nickel plated.

**HOUSING:** Stainless.

**SWITCH SUPPORT:** Brass.tin plated.

**CONTACT/TERMINAL:**Brass, with silver or gold plated. (See Page 120)



## HOW TO ORDER

MODEL NO. ACTUATOR BUSHING TERMINATIONS TERMINAL PLATING SEAL RoHS SOLDERING ADDITIONAL HARDWARE CAPS CAP COLOR



Model NO.  
**8MSL** On-On

Actuator  
**P1** 4.29 high

Bushing  
**B05** 5.24 high,flat (thd)  
**B06** 5.24 high,flat (non-thd)

Seal  
**E** EPOXY (std)  
**N** NO EPOXY

RoHS soldering  
**S** RoHS & Lead Free

Caps  
(See Page 117)  
**C1**  
**C3**  
**C4**

Terminal plating  
**Q** Silver  
**R** Gold  
**C** Gold over silver

Additional hardware  
**0** Without  
**5** Additional hardware

Terminations  
**M1** Solder Lug  
**M2** PC thru-hole  
**M5** Wire wrap  
**M6** Right angle, PC thru-hole  
**M7** Vertical right angle, PC thru-hole  
**VS2** 8.94 high, V-bracket

CAP Color

ITEM NO	COLOR
1	White
2	Black (Std)
3	Red
4	Orange
5	Yellow
6	Green
7	Blue
8	Brown
9	Gray

\* Besides standard color, other colors need to check stocks available.

8M(LOCK) Pushbutton Switches

## SWITCH FUNCTION

NO. POLES	UL/CSA MODEL NO.	MODEL NO.	SWITCH FUNCTION		CONNECTED TERMINALS / SCHEMATIC	
			POS.1	POS.2	POS.1	POS.2
SP	Q28	8MSL	ON	ON	2-1 NC 1  2 (COMM) • 3 NO	2-3 NC 1  2 (COMM) • 3 NO

## POLE OPTIONS

### M1

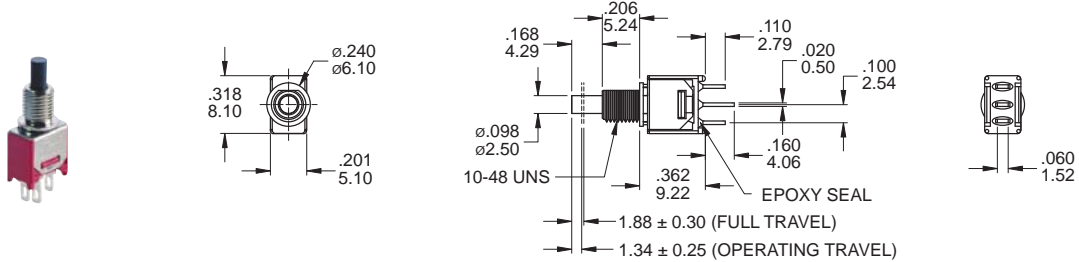

### SPDT

Part No. Shown : 8MSLP1B05M1QE

### M2

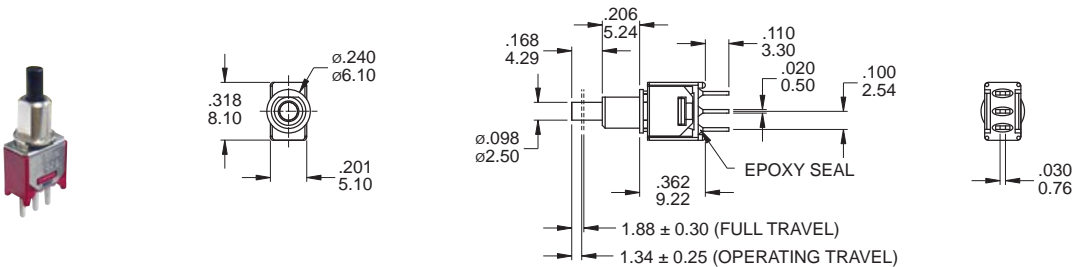

### SPDT

Part No. Shown : 8MSLP1B06M2QE

## BUSHING AND TERMINATION OPTIONS

### B05 THD

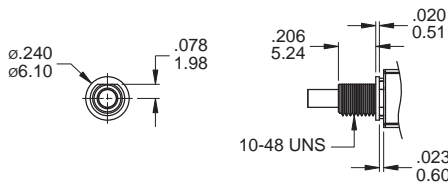

### B06 NON-THD

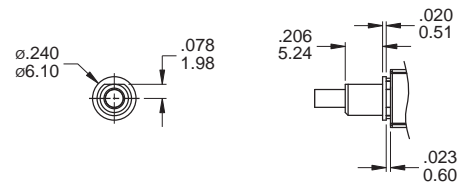

### M1 Solder lug

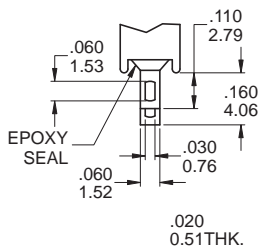

### M2 PC Thru-hole

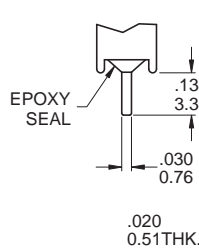

### M5 Wire Wrap

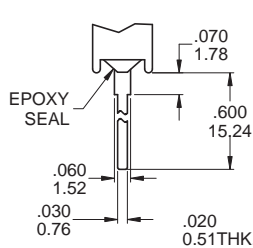

### OTHER TERMINATION OPTIONS

- M6** Right angle P.C. Mount
- M7** Right angle P.C. Mount
- VS2** Vertical bracket P.C. Mount



# 8M(LOCK) Series

Sub-Miniature Pushbutton Switches

M6

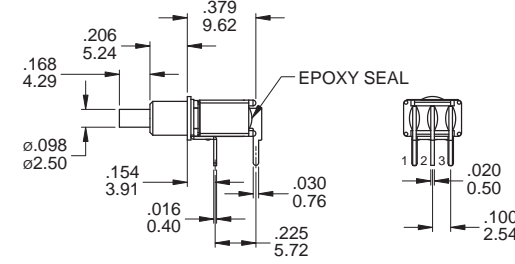
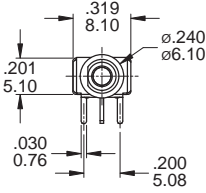

P.C. MOUNTING

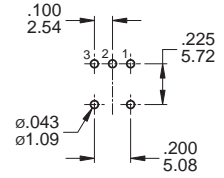

SPDT

Part No. Shown : 8MSLP1B06M6QE

M7

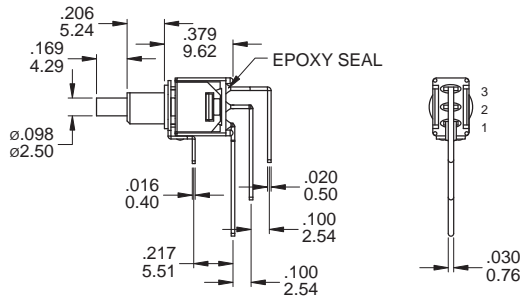
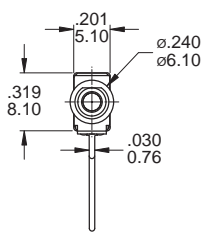

P.C. MOUNTING

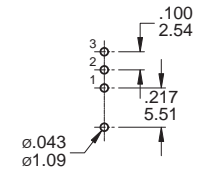

SPDT

Part No. Shown : 8MSLP1B06M7QE

VS2

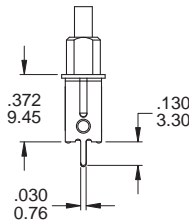
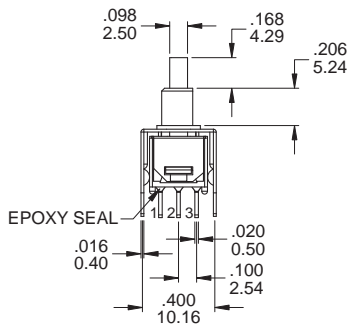

P.C. MOUNTING

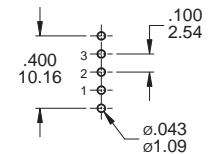

SPDT

Part No. Shown : 8MSLP1B06VS2QE

## CONTACT MATERIAL OPTIONS

	CONTACT PLATING	TERMINAL PLATING	RATINGS
Q	Silver	Q = Silver	3 Amps with resistant load @ 120VAC or 28VDC 1 Amps with resistant load @ 250VAC
C	Gold over Silver	C = Gold over silver	
R	Gold	R = Gold	0.4 Volt - Amps ( VA ) max. @ 20V max. ( AC or DC )

## SOLDERING PROCESSES

**MANUAL SOLDERING:** Use soldering iron of 30 watts, controlled at 350°C approximately 5 seconds while applying solder.

**WAVE SOLDERING:** Recommended Soldering Temperature: 270 ± 5°C  
Duration of Solder Immersion: Max 5 sec. (PCB is 1.6mm in thickness)

Part No. Shown : 8MD9P1B10M2RE