



WINSTAR Display Co.,Ltd.
華凌光電股份有限公司



Winstar Display Co., LTD

華凌光電股份有限公司



WEB: <http://www.winstar.com.tw> E-mail: sales@winstar.com.tw

SPECIFICATION

MODULE NO.: WF101FSYFPLHTX#

General Specifications

Item	Dimension	Unit
Screen Diagonal	10.1	inch
Number of Pixels	1280 x 3(RGB) x 800	dots
Module dimension	230.56 x 155.01 x 27.7	mm
Active area	216.96 (H) x 135.6(V)	mm
Pixel pitch	0.1695 x 0.1695	mm
Display Mode	Normally Black	
Pixel Arrangement	R.G.B. Vertical Stripe	
Backlight Type	LED, Normally White	
Aspect Ratio	16:9	
Electrical Interface (Logic)	HDMI	
Touch Panel	With RTP	
Surface	Anti-Glare	

*Color tone slight changed by temperature and driving voltage.

Absolute Maximum Ratings

Item	Symbol	Min	Typ	Max	Unit
Operating Temperature	TOP	-20	—	+70	°C
Storage Temperature	TST	-20	—	+70	°C

Electrical Characteristics

Typical Operation Conditions

Item	Symbol	Values			Unit
		Min	Typ	MAX	
Power voltage	VDD	4.5	5.0	5.5	V

Interface

1. CON5/CON6

Pin No.	Symbol	Function
1	3.3V	Raspberry Pi:Power 3.3V
2	5V	Raspberry Pi:Power 5V
3	SDA	CTP_SDA (For CTP type Reserved)
4	5V	Raspberry Pi:Power 5V
5	SCL	CTP_SCL (For CTP type Reserved)
6	GND	Raspberry Pi:GND
7	GPIO04	Raspberry Pi:GPIO04
8	GPIO14	Raspberry Pi:GPIO14
9	GND	Raspberry Pi:GND
10	GPIO15	Raspberry Pi:GPIO15
11	RST	CTP_RST (For CTP type Reserved)
12	ACTIVE	GPIO
13	WAKE	CTP_WAKE (For CTP type Reserved)
14	GND	Raspberry Pi:GND
15	INT	CTP_INT (For CTP type Reserved)
16	GPIO23	Raspberry Pi:GPIO23
17	3.3V	Power Supply
18	GPIO24	Raspberry Pi:GPIO24
19	GPIO10	Raspberry Pi:GPIO10
20	GND	Raspberry Pi:GND
21	GPIO09	Raspberry Pi:GPIO09
22	GPIO25	Raspberry Pi:GPIO25
23	GPIO11	Raspberry Pi:GPIO11
24	GPIO08	Raspberry Pi:GPIO08
25	GND	Raspberry Pi:GND
26	GPIO07	Raspberry Pi:GPIO07
27	ID_SD	Raspberry Pi:ID_SD
28	ID_SC	Raspberry Pi:ID_SC
29	GPIO05	Raspberry Pi:GPIO05

30	GND	Raspberry Pi:GND
31	GPIO06	Raspberry Pi:GPIO06
32	GPIO12	Raspberry Pi:GPIO12
33	GPIO13	Raspberry Pi:GPIO13
34	GND	Raspberry Pi:GND
35	GPIO19	Raspberry Pi:GPIO19
36	GPIO16	Raspberry Pi:GPIO16
37	GPIO26	Raspberry Pi:GPIO26
38	GPIO20	Raspberry Pi:GPIO20
39	GND	Raspberry Pi:GND
40	GPIO21	Raspberry Pi:GPIO21

2. HDMI

Pin No.	Symbol	I/O	Function
1	Rx2+	I	+LVDS Differential Data Input
2	GND	P	Ground
3	Rx2-	I	-LVDS Differential Data Input
4	Rx1+	I	+LVDS Differential Data Input
5	GND	P	Ground
6	Rx1-	I	-LVDS Differential Data Input
7	Rx0+	I	+LVDS Differential Data Input
8	GND	P	Ground
9	Rx0-	I	-LVDS Differential Data Input
10	RxC+	I	+LVDS Differential Clock Input
11	GND	P	Ground
12	RxC-	I	-LVDS Differential Clock Input
13-14	NC	-	No connection
15	SCL	I/O	DDC(Data Display Channel) Clock
16	SDA	I/O	DDC(Data Display Channel) Data
17	GND	P	Ground
18	5V	P	Power Supply
19	Detect	I/O	Hot plug detect

I: input, O: output, P: Power

3. USB

Pin No.	Symbol	I/O	Function
1	5V	P	Power Supply
2	D-	I/O	USB Data -
3	D+	I/O	USB Data +
4	NC	-	No connection
5	GND	P	Ground

4. J2

Pin No.	Symbol	I/O	Function
1	VLED+	P	Power Supply
2	VLED-	P	Ground
3	NC		No connection

Contour Drawing

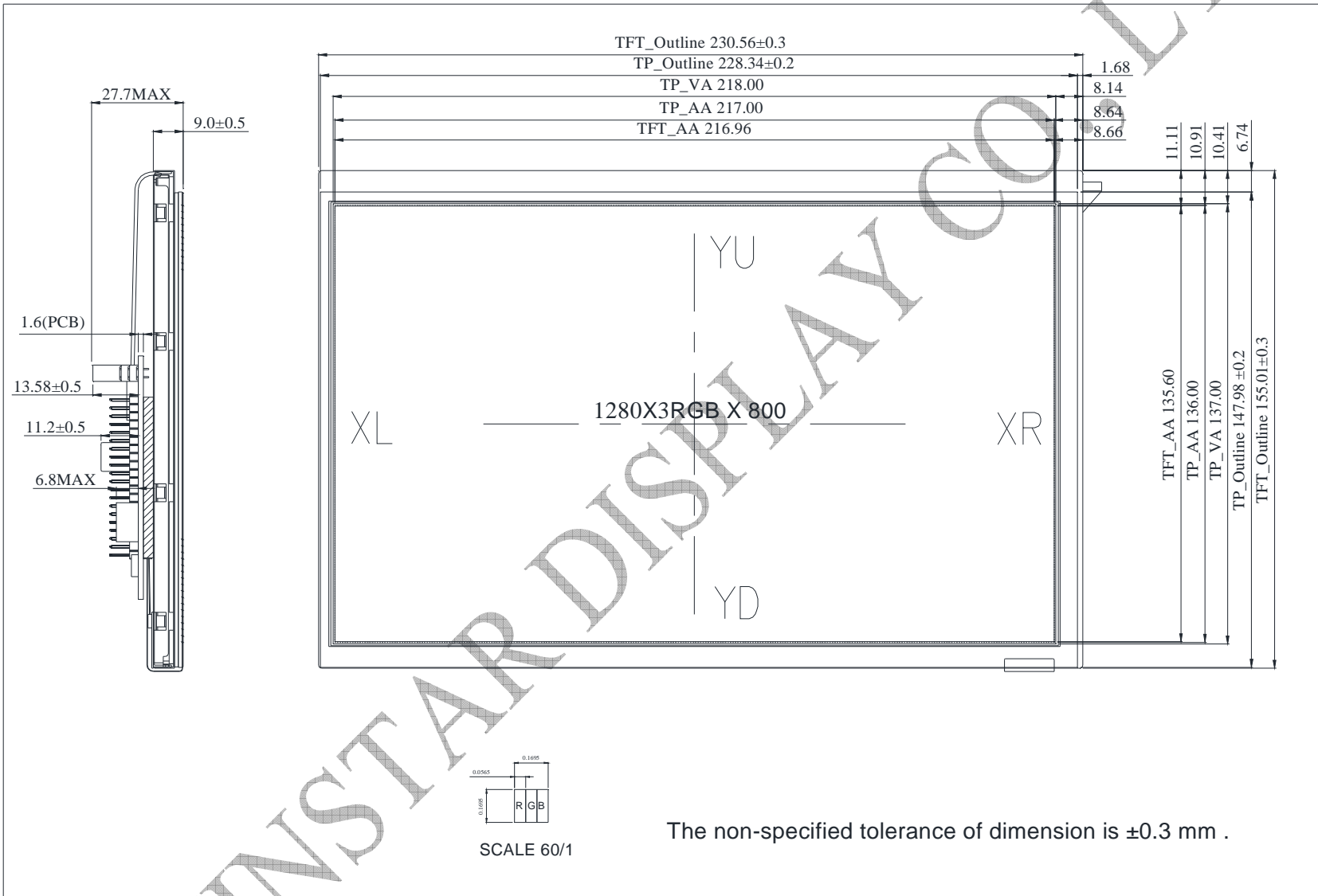

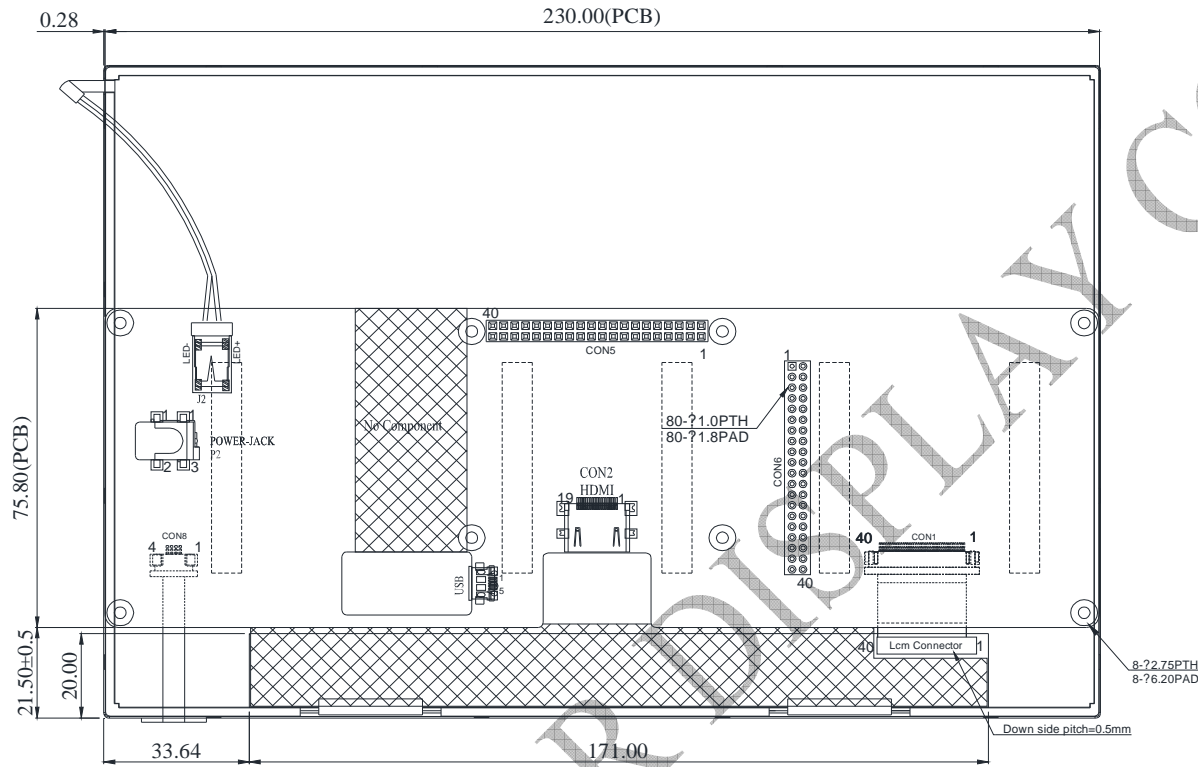

CON5/6

Pin	Symbol	Pin	Symbol
1	3.3V	21	GPIO09
2	5V	22	GPIO25
3	SDA	23	GPIO11
4	5V	24	GPIO08
5	SCL	25	GND
6	GND	26	GPIO07
7	GPIO04	27	ID_SD
8	GPIO14	28	ID_SC
9	GND	29	GPIO05
10	GPIO15	30	GND
11	RST	31	GPIO06
12	ACTIVE	32	GPIO12
13	WAKE	33	GPIO13
14	GND	34	GND
15	INT	35	GPIO19
16	GPIO23	36	GPIO16
17	3.3V	37	GPIO26
18	GPIO24	38	GPIO20
19	GPIO10	39	GND
20	GND	40	GPIO21

The non-specified tolerance of dimension is ± 0.3 mm .